

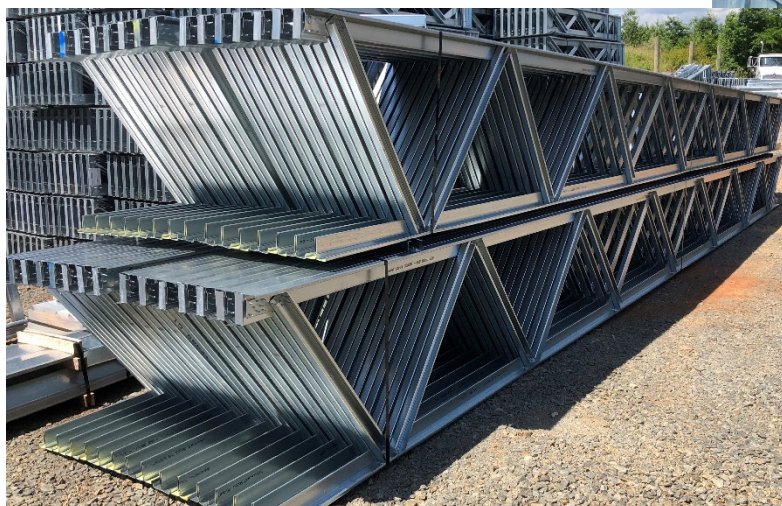

*The Only Cold Formed Steel Truss Designed Specifically for Flat Roof and Floor Applications*

### ADVANT Bar Joist Replacement



### Why **ADVANT** instead of Bar Joist?

Cold-formed steel trusses provide enormous design flexibility that does not exist with hot-rolled heavy steel joists. Unlimited depth and spacing combinations allow a customized and engineered solution that is built around project loading and deflection criteria. In addition, end bearing conditions (top-chord, mid-chord, ledger supported, etc.) can be tailored around project-specific requirements.

### Conversion **LOAD TABLES**

Tables are to be used for basic load carrying comparison for replacement of K-Series and LH Series joists. All Advant cold-formed steel trusses will be designed for actual spans, depth & loads specified by building designer and/or project Engineer-Of-Record. Individual truss designs, signed & sealed by a registered Professional Engineer, will be provided.

The **BLACK** figures in the Load Tables represent the TOTAL uniform load carrying capacity (PLF). The **RED** figures represent the TOTAL uniform load to meet L/360 deflection criteria (PLF).

Floor applications require 600S162-33 strongbacks at approximately 10'-0" on-center. Roof applications will require a bottom chord lateral and diagonal restraint system.

All top chords are assumed to be continuously sheathed. No allowance for mechanical units, snow drift, etc. has been included in the load tables. Floor applications with stack loads from above may require additional reinforcement at bearing supports.

For additional span/depth/spacing/loading combinations and quotations, including increased capacity and/or span, contact Advant Steel ([www.advantsteel.com](http://www.advantsteel.com)).



**K Series to ADVANT - Conversion LOAD TABLE**

STANDARD LOAD TABLE FOR **ADVANT** PARALLEL CHORD TRUSSES. Loads shown in Pounds Per Linear Foot (plf)

ADVANT Designation	12T-33	12T-43	12T-54	12T-68	12T-97	14T-33	14T-43	14T-54	14T-68	14T-97	16T-33	16T-43	16T-54	16T-68	16T-97
Depth (in.)	12	12	12	12	12	14	14	14	14	14	16	16	16	16	16
Approx. Wt (lbs./ft.)	3.5	4.2	5.0	5.9	8.1	3.5	4.2	5.0	5.9	8.1	3.6	4.3	5.1	6.1	8.2
Span (ft.)															
10	340 340	576 576	673 673	810 810	886 886										
11	309 309	469 469	563 563	716 716	796 796										
12	283 283	379 379	530 530	590 590	743 743	313 313									
13	236 236	329 329	440 440	515 515	707 707	281 281									
14	201 201	300 300	372 372	470 470	650 650	237 237	356 356	438 438	555 555		258 258				
15	183 183	247 247	341 341	391 391	533 533	217 217	298 298	403 403	475 475		241 241				
16	164 164	237 237	313 284	380 380	520 470	199 199	288 288	379 379	446 446	634 634	232 232	340 340	434 434	550 550	
17	147 147	206 198	248 240	329 327	452 413	178 178	250 250	346 337	400 400	548 548	210 210	292 292	403 403	470 470	
18	131 130	178 168	252 204	284 275	392 353	159 159	214 214	309 289	341 341	470 470	187 187	248 248	365 365	398 398	549 549
19	116 111	163 145	222 175	260 246	358 303	140 140	195 195	271 248	312 308	428 410	164 164	227 227	318 318	363 363	495 495
20	102 96	150 122	194 152	240 206	333 268	123 123	180 177	234 212	289 245	398 360	143 143	210 210	273 273	338 338	464 464
21	94 84	134 108	179 132	216 177	296 231	113 113	161 151	215 187	261 211	360 318	131 131	190 190	250 247	307 307	426 411
22	87 73	128 94	167 117	206 151	285 200	105 104	155 132	201 162	254 184	351 280	122 122	184 179	235 217	299 290	409 360
23			155 102	186 132	257 176	97 90	140 117	188 143	228 161	316 247	114 114	165 156	222 192	269 253	373 317
24			130 89	166 116	230 156	90 80	125 102	176 128	202 142	280 219	106 106	147 131	208 170	237 223	328 287
25			159 100	214 139	283 179	83 71	116 91	163 113	188 125	260 195	98 95	136 122	193 151	221 197	305 256
26			144 89	201 125	279 179	109 81	149 101	176 112	245 173	300 212	90 85	128 108	175 135	207 175	287 229
27			179 109	214 139	283 179	83 71	116 91	163 113	188 125	260 195	98 95	136 122	193 151	221 197	305 256
28			169 99	214 139	283 179	83 71	116 91	163 113	188 125	260 195	98 95	136 122	193 151	221 197	305 256
29			169 99	214 139	283 179	83 71	116 91	163 113	188 125	260 195	98 95	136 122	193 151	221 197	305 256
30			169 99	214 139	283 179	83 71	116 91	163 113	188 125	260 195	98 95	136 122	193 151	221 197	305 256
31			169 99	214 139	283 179	83 71	116 91	163 113	188 125	260 195	98 95	136 122	193 151	221 197	305 256
32			169 99	214 139	283 179	83 71	116 91	163 113	188 125	260 195	98 95	136 122	193 151	221 197	305 256
33			169 99	214 139	283 179	83 71	116 91	163 113	188 125	260 195	98 95	136 122	193 151	221 197	305 256
34			169 99	214 139	283 179	83 71	116 91	163 113	188 125	260 195	98 95	136 122	193 151	221 197	305 256
35			169 99	214 139	283 179	83 71	116 91	163 113	188 125	260 195	98 95	136 122	193 151	221 197	305 256
36			169 99	214 139	283 179	83 71	116 91	163 113	188 125	260 195	98 95	136 122	193 151	221 197	305 256

- This Span Table is intended for reference only; **ADVANT** parallel chord trusses are available in virtually any span/depth; Consult **ADVANT** or your local **ADVANT** fabricator

- Loads given are the TOTAL safe uniformly distributed load carrying capacity in pounds per lin-ft of ASD T-Series **ADVANT** Parallel Chord Trusses

- The **BLACK** figures in the Load Table Represent the TOTAL uniform load carrying capacity (PLF).

- The **RED** figures represent the TOTAL uniform load to meet L/360 deflection criteria (PLF).

- 600S162-43 Strongbacks should be used at max 10' oc along Truss span for reduced vibration



**K Series to ADVANT - Conversion LOAD TABLE**

STANDARD LOAD TABLE FOR **ADVANT** PARALLEL CHORD TRUSSES. Loads shown in Pounds Per Linear Foot (plf)

ADVANT Designation	18T-33	18T-43	18T-54	18T-68	18T-97	20T-33	20T-43	20T-54	20T-68	20T-97	22T-33	22T-43	22T-54	22T-68	22T-97
Depth (in.)	18	18	18	18	18	20	20	20	20	20	22	22	22	22	22
Approx. Wt (lbs./ft.)	3.5	4.3	5.2	6.1	8.2	3.6	4.3	5.3	6.1	8.2	3.7	4.5	5.4	6.5	8.7
Span (ft.)															
16	239 239					242 242					248 248				
17	227 227					231 231					242 242				
18	214 214	282 282	419 419	450 450		222 222	330 330	443 443	537 537		226 226	335 335	442 442		
19	187 187	257 257	363 363	412 412		210 210	299 299	407 407	489 489		219 219	325 325	439 439		
20	162 162	240 240	310 310	385 385	527 527	181 181	255 255	346 346	407 407	531 531	199 199	280 280	380 380	451 451	522 522
21	149 149	217 217	284 284	351 351	485 485	166 166	235 235	318 318	377 377	506 506	182 182	257 257	349 349	412 412	499 499
22	139 139	210 210	266 266	340 340	469 469	155 155	219 219	297 297	350 350	480 480	170 170	240 240	326 326	384 384	475 475
23	130 130	189 189	253 253	310 310	428 428	147 147	208 208	284 284	335 335	458 458	162 162	230 230	314 314	369 369	453 453
24	122 122	168 168	238 238	271 271	375 375	138 138	195 195	266 266	315 315	432 432	152 152	215 215	294 294	347 347	433 433
25	113 113	156 156	223 223	252 252	348 348	128 128	183 183	252 252	299 299	409 409	142 142	204 204	280 280	330 330	415 415
26	103 103	146 139	202 172	237 228	329 289	116 116	166 166	227 214	270 263	375 347	129 129	184 184	252 252	300 300	398 398
27	93 93	136 125	180 155	223 203	307 261	104 104	148 148	202 193	238 237	331 312	115 115	164 164	223 223	263 263	366 366
28	88 88	131 112	170 140	213 183	296 245	98 98	140 140	191 174	225 214	312 284	109 109	155 155	211 210	249 249	346 340
29		121 101	161 126	200 164	276 215	93 93	133 127	181 157	213 194	297 258	103 103	147 147	200 190	236 234	328 309
30		111 92	151 115	181 148	249 192		124 115	171 142	202 177	274 235	96 96	138 138	190 173	225 213	310 282
31		104 84	145 104	170 135	235 173		120 105	164 130	194 160	270 215	93 93	133 127	182 157	214 194	300 258
32		99 77	138 94	162 122	222 163		113 95	156 118	185 147	259 199	88 88	126 116	174 144	206 178	288 237
33			127 87	153 112	211 149		105 87	144 107	171 134	236 182		116 106	160 132	191 163	263 217
34				146 102	202 135		97 80	133 100	157 124	217 168		108 97	148 121	175 149	242 201
35				139 94	193 123			127 92	150 114	207 155		103 89	141 111	166 137	230 186
36				128 86	177 116			122 84	143 106	199 144		98 83	135 103	160 127	221 173
37				168 107				116 78	137 97	190 132		94 76	129 95	153 118	211 160
38					161 99			110 71	131 90	169 123			124 88	147 109	203 148
39								106 67	127 83	175 114			118 81	141 101	195 138
40								101 62	116 77	161 105			109 76	130 94	180 128
41									111 72	153 99			104 70	123 87	171 120
42										147 92				118 81	164 112
43										142 86				114 76	159 104

- This Span Table is intended for reference only; **ADVANT** parallel chord trusses are available in virtually any span/depth; Consult **ADVANT** or your local **ADVANT** fabricator

- Loads given are the TOTAL safe uniformly distributed load carrying capacity in pounds per lin-ft of ASD T-Series **ADVANT** Parallel Chord Trusses

- The **BLACK** figures in the Load Table Represent the TOTAL uniform load carrying capacity (PLF).

- The **RED** figures represent the TOTAL uniform load to meet L/360 deflection criteria (PLF).

- 600S162-43 Strongbacks should be used at max 10' oc along Truss span for reduced vibration



**LH Series to ADVANT - Conversion LOAD TABLE**

STANDARD LOAD TABLE FOR **ADVANT** PARALLEL CHORD TRUSSES. Loads shown in Pounds Per Linear Foot (plf)

Truss ID	Weight (lb/ft)	Depth in Inches	SPAN IN FEET							
			30	32	34	36	38	40	42	44
24T-33	3.8	24	106 <b>106</b>	97 <b>97</b>	83 <b>83</b>	76 <b>76</b>	69 <b>65</b>			
24T-43	4.4	24	152 <b>152</b>	139 <b>137</b>	119 <b>115</b>	108 <b>98</b>	99 <b>84</b>	88 <b>73</b>	80 <b>63</b>	74 <b>55</b>
24T-54	5.1	24	210 <b>210</b>	186 <b>177</b>	170 <b>148</b>	149 <b>125</b>	135 <b>106</b>	124 <b>91</b>	112 <b>79</b>	102 <b>68</b>
24T-68	6.1	24	250 <b>250</b>	221 <b>221</b>	201 <b>191</b>	178 <b>161</b>	161 <b>137</b>	148 <b>118</b>	133 <b>102</b>	122 <b>88</b>
24T-97	8.7	24	330 <b>329</b>	278 <b>277</b>	249 <b>242</b>	229 <b>207</b>	215 <b>177</b>	186 <b>153</b>	170 <b>132</b>	159 <b>117</b>
28T-33	3.8	28	125 <b>125</b>	115 <b>115</b>	98 <b>98</b>	89 <b>89</b>	82 <b>82</b>	72 <b>72</b>	66 <b>66</b>	
28T-43	4.5	28	179 <b>179</b>	164 <b>164</b>	140 <b>140</b>	128 <b>128</b>	117 <b>114</b>	104 <b>99</b>	95 <b>85</b>	88 <b>75</b>
Truss ID	Weight (lb/ft)	Depth in Inches	SPAN IN FEET							
			46	48	50	52	54	56	58	60
28T-54	5.5	28	113 <b>83</b>	103 <b>73</b>	95 <b>65</b>	86 <b>58</b>				
28T-68	6.5	28	134 <b>108</b>	123 <b>95</b>	113 <b>84</b>	103 <b>75</b>				
28T-97	8.7	28	169 <b>142</b>	159 <b>126</b>	150 <b>112</b>	139 <b>101</b>	130 <b>90</b>			
32T-54	5.5	32	130 <b>110</b>	119 <b>97</b>	110 <b>86</b>	100 <b>76</b>	94 <b>68</b>			
32T-68	6.5	32	155 <b>143</b>	142 <b>126</b>	131 <b>111</b>	118 <b>99</b>	111 <b>89</b>			
32T-97	8.8	32	194 <b>184</b>	182 <b>163</b>	173 <b>146</b>	160 <b>130</b>	150 <b>117</b>	137 <b>105</b>		
36T-54	5.5	36	147 <b>141</b>	135 <b>124</b>	124 <b>110</b>	113 <b>98</b>	106 <b>87</b>	94 <b>78</b>		
36T-68	6.5	36	175 <b>175</b>	160 <b>160</b>	148 <b>143</b>	134 <b>127</b>	126 <b>113</b>	111 <b>102</b>		
36T-97	9.0	36	217 <b>217</b>	205 <b>202</b>	195 <b>180</b>	181 <b>161</b>	170 <b>146</b>	155 <b>132</b>	145 <b>120</b>	138 <b>109</b>
40T-54	5.5	40	151 <b>151</b>	142 <b>142</b>	138 <b>137</b>	126 <b>122</b>	118 <b>109</b>	105 <b>98</b>	97 <b>88</b>	93 <b>80</b>
40T-68	6.5	40	194 <b>194</b>	168 <b>168</b>	166 <b>166</b>	149 <b>149</b>	140 <b>140</b>	125 <b>125</b>	116 <b>114</b>	110 <b>103</b>
40T-97	9.4	40	240 <b>240</b>	228 <b>228</b>	217 <b>216</b>	201 <b>195</b>	189 <b>175</b>	173 <b>159</b>	160 <b>144</b>	154 <b>132</b>
44T-54	5.5	44	180 <b>180</b>	156 <b>156</b>	152 <b>152</b>	138 <b>138</b>	130 <b>130</b>	116 <b>116</b>	107 <b>107</b>	103 <b>97</b>
44T-68	6.5	44	186 <b>186</b>	184 <b>184</b>	173 <b>173</b>	160 <b>160</b>	154 <b>154</b>	137 <b>137</b>	127 <b>127</b>	122 <b>122</b>
44T-97	9.6	44	260 <b>260</b>	244 <b>244</b>	233 <b>233</b>	220 <b>220</b>	207 <b>207</b>	190 <b>186</b>	176 <b>176</b>	170 <b>154</b>
48T-54	5.8	48	169 <b>169</b>	168 <b>168</b>	160 <b>160</b>	145 <b>145</b>	137 <b>137</b>	126 <b>126</b>	117 <b>117</b>	112 <b>112</b>
48T-68	6.8	48	186 <b>186</b>	184 <b>184</b>	173 <b>173</b>	164 <b>164</b>	157 <b>157</b>	149 <b>149</b>	138 <b>138</b>	133 <b>133</b>
48T-97	9.7	48	262 <b>262</b>	251 <b>251</b>	239 <b>239</b>	237 <b>237</b>	224 <b>224</b>	207 <b>207</b>	192 <b>192</b>	185 <b>178</b>

- This Span Table is intended for reference only; **ADVANT** parallel chord trusses are available in virtually any span/depth; Consult **ADVANT** or your local **ADVANT** fabricator
- Loads given are the TOTAL safe uniformly distributed load carrying capacity in pounds per lin-ft of ASD T-Series **ADVANT** Parallel Chord Trusses
- The **BLACK** figures in the Load Table Represent the TOTAL uniform load carrying capacity (PLF).
- The **RED** figures represent the TOTAL uniform load to meet L/360 deflection criteria (PLF).
- 600S162-43 Strongbacks should be used at max 10' oc along Truss span for reduced vibration



# Section 05 44 00 Cold Formed Steel Trusses

